

GENERAL NOTES

1. The applicant shall provide a site plan showing the vertical layout for all impervious paved areas to be installed. The applicant shall provide a site plan showing the vertical layout for all impervious paved areas to be installed.

2. BMPs shall be installed in accordance with the following specifications:

3. The applicant shall provide a site plan showing the vertical layout for all impervious paved areas to be installed.

4. The applicant shall provide a site plan showing the vertical layout for all impervious paved areas to be installed.

STANDARD DETAILS

NO.	NAME	DESCRIPTION
101	Standard Detail 101	Standard Detail 101
102	Standard Detail 102	Standard Detail 102
103	Standard Detail 103	Standard Detail 103
104	Standard Detail 104	Standard Detail 104
105	Standard Detail 105	Standard Detail 105
106	Standard Detail 106	Standard Detail 106
107	Standard Detail 107	Standard Detail 107
108	Standard Detail 108	Standard Detail 108
109	Standard Detail 109	Standard Detail 109
110	Standard Detail 110	Standard Detail 110
111	Standard Detail 111	Standard Detail 111
112	Standard Detail 112	Standard Detail 112
113	Standard Detail 113	Standard Detail 113
114	Standard Detail 114	Standard Detail 114
115	Standard Detail 115	Standard Detail 115
116	Standard Detail 116	Standard Detail 116
117	Standard Detail 117	Standard Detail 117
118	Standard Detail 118	Standard Detail 118
119	Standard Detail 119	Standard Detail 119
120	Standard Detail 120	Standard Detail 120



GENERAL NOTES

1. The applicant shall provide a site plan showing the vertical layout for all impervious paved areas to be installed. The applicant shall provide a site plan showing the vertical layout for all impervious paved areas to be installed.

2. BMPs shall be installed in accordance with the following specifications:

3. The applicant shall provide a site plan showing the vertical layout for all impervious paved areas to be installed.

4. The applicant shall provide a site plan showing the vertical layout for all impervious paved areas to be installed.

GENERAL NOTES

1. The applicant shall provide a site plan showing the vertical layout for all impervious paved areas to be installed. The applicant shall provide a site plan showing the vertical layout for all impervious paved areas to be installed.

2. BMPs shall be installed in accordance with the following specifications:

3. The applicant shall provide a site plan showing the vertical layout for all impervious paved areas to be installed.

4. The applicant shall provide a site plan showing the vertical layout for all impervious paved areas to be installed.

GENERAL NOTES

1. The applicant shall provide a site plan showing the vertical layout for all impervious paved areas to be installed. The applicant shall provide a site plan showing the vertical layout for all impervious paved areas to be installed.

2. BMPs shall be installed in accordance with the following specifications:

3. The applicant shall provide a site plan showing the vertical layout for all impervious paved areas to be installed.

4. The applicant shall provide a site plan showing the vertical layout for all impervious paved areas to be installed.

GENERAL NOTES

1. The applicant shall provide a site plan showing the vertical layout for all impervious paved areas to be installed. The applicant shall provide a site plan showing the vertical layout for all impervious paved areas to be installed.

2. BMPs shall be installed in accordance with the following specifications:

3. The applicant shall provide a site plan showing the vertical layout for all impervious paved areas to be installed.

4. The applicant shall provide a site plan showing the vertical layout for all impervious paved areas to be installed.

GENERAL NOTES

1. The applicant shall provide a site plan showing the vertical layout for all impervious paved areas to be installed. The applicant shall provide a site plan showing the vertical layout for all impervious paved areas to be installed.

2. BMPs shall be installed in accordance with the following specifications:

3. The applicant shall provide a site plan showing the vertical layout for all impervious paved areas to be installed.

4. The applicant shall provide a site plan showing the vertical layout for all impervious paved areas to be installed.



Project No.	2019-104517-GP1
Client	WINDSOR WEST
Site	1025 SOUTH STREET, WESTYORK, NEW YORK
Scale	AS SHOWN
Date	08/02/2019
Drawn by	JH
Checked by	MJH
Project	Grading & Stormwater Pollution Prevention Plan

Grading Permit: PCWP No. SAR-2019104517-GP1

SWPPP PLAN

WINDSOR WEST
1025 SOUTH STREET, WESTYORK, NEW YORK
GRADING & STORMWATER POLLUTION PREVENTION PLAN

E & A CONSULTING GROUP, INC.
Engineering • Planning • Environmental & Risk Services
E & A CONSULTING GROUP, INC.
100 WEST 42ND STREET, 17TH FLOOR
NEW YORK, NY 10018
Tel: (212) 904-7200

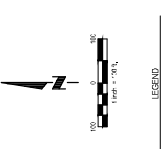

LEGEND

- Proposed Contour
- Existing Contour
- ▬ Final Slope
- ▬ Proposed Slope
- ▬ Erosion Control (Proposed)
- ▬ Erosion Control (Existing)
- ▬ Erosion Control (Temporary)
- ▬ Erosion Control (Final)
- ▬ Erosion Control (Type 'A')
- ▬ Erosion Control (Type 'B')
- ▬ Erosion Control (Type 'C')
- ▬ Erosion Control (Type 'D')
- ▬ Erosion Control (Type 'E')
- ▬ Erosion Control (Type 'F')
- ▬ Erosion Control (Type 'G')
- ▬ Erosion Control (Type 'H')
- ▬ Erosion Control (Type 'I')
- ▬ Erosion Control (Type 'J')
- ▬ Erosion Control (Type 'K')
- ▬ Erosion Control (Type 'L')
- ▬ Erosion Control (Type 'M')
- ▬ Erosion Control (Type 'N')
- ▬ Erosion Control (Type 'O')
- ▬ Erosion Control (Type 'P')
- ▬ Erosion Control (Type 'Q')
- ▬ Erosion Control (Type 'R')
- ▬ Erosion Control (Type 'S')
- ▬ Erosion Control (Type 'T')
- ▬ Erosion Control (Type 'U')
- ▬ Erosion Control (Type 'V')
- ▬ Erosion Control (Type 'W')
- ▬ Erosion Control (Type 'X')
- ▬ Erosion Control (Type 'Y')
- ▬ Erosion Control (Type 'Z')

GRADING & EROSION CONTROL REFERENCE NOTES

001. Contour Interval: 0.5' (1:24)
002. Contour Interval: 1.0' (1:12)
003. Contour Interval: 1.5' (1:8)
004. Contour Interval: 2.0' (1:6)
005. Contour Interval: 2.5' (1:4.8)
006. Contour Interval: 3.0' (1:4)
007. Contour Interval: 3.5' (1:3.4)
008. Contour Interval: 4.0' (1:3)
009. Contour Interval: 4.5' (1:2.7)
010. Contour Interval: 5.0' (1:2.4)
011. Contour Interval: 5.5' (1:2.2)
012. Contour Interval: 6.0' (1:2)
013. Contour Interval: 6.5' (1:1.8)
014. Contour Interval: 7.0' (1:1.6)
015. Contour Interval: 7.5' (1:1.4)
016. Contour Interval: 8.0' (1:1.3)
017. Contour Interval: 8.5' (1:1.2)
018. Contour Interval: 9.0' (1:1.1)
019. Contour Interval: 9.5' (1:1)
020. Contour Interval: 10.0' (1:1)
021. Contour Interval: 10.5' (1:1)
022. Contour Interval: 11.0' (1:1)
023. Contour Interval: 11.5' (1:1)
024. Contour Interval: 12.0' (1:1)
025. Contour Interval: 12.5' (1:1)
026. Contour Interval: 13.0' (1:1)
027. Contour Interval: 13.5' (1:1)
028. Contour Interval: 14.0' (1:1)
029. Contour Interval: 14.5' (1:1)
030. Contour Interval: 15.0' (1:1)

CONTRACT MATERIALS

1. Subgrade: 18" (457 mm) of compacted subgrade
2. Subgrade: 18" (457 mm) of compacted subgrade
3. Subgrade: 18" (457 mm) of compacted subgrade
4. Subgrade: 18" (457 mm) of compacted subgrade
5. Subgrade: 18" (457 mm) of compacted subgrade
6. Subgrade: 18" (457 mm) of compacted subgrade
7. Subgrade: 18" (457 mm) of compacted subgrade
8. Subgrade: 18" (457 mm) of compacted subgrade
9. Subgrade: 18" (457 mm) of compacted subgrade
10. Subgrade: 18" (457 mm) of compacted subgrade
11. Subgrade: 18" (457 mm) of compacted subgrade
12. Subgrade: 18" (457 mm) of compacted subgrade
13. Subgrade: 18" (457 mm) of compacted subgrade
14. Subgrade: 18" (457 mm) of compacted subgrade
15. Subgrade: 18" (457 mm) of compacted subgrade
16. Subgrade: 18" (457 mm) of compacted subgrade
17. Subgrade: 18" (457 mm) of compacted subgrade
18. Subgrade: 18" (457 mm) of compacted subgrade
19. Subgrade: 18" (457 mm) of compacted subgrade
20. Subgrade: 18" (457 mm) of compacted subgrade

CONTRACT SCHEDULE

1. Subgrade: 18" (457 mm) of compacted subgrade
2. Subgrade: 18" (457 mm) of compacted subgrade
3. Subgrade: 18" (457 mm) of compacted subgrade
4. Subgrade: 18" (457 mm) of compacted subgrade
5. Subgrade: 18" (457 mm) of compacted subgrade
6. Subgrade: 18" (457 mm) of compacted subgrade
7. Subgrade: 18" (457 mm) of compacted subgrade
8. Subgrade: 18" (457 mm) of compacted subgrade
9. Subgrade: 18" (457 mm) of compacted subgrade
10. Subgrade: 18" (457 mm) of compacted subgrade
11. Subgrade: 18" (457 mm) of compacted subgrade
12. Subgrade: 18" (457 mm) of compacted subgrade
13. Subgrade: 18" (457 mm) of compacted subgrade
14. Subgrade: 18" (457 mm) of compacted subgrade
15. Subgrade: 18" (457 mm) of compacted subgrade
16. Subgrade: 18" (457 mm) of compacted subgrade
17. Subgrade: 18" (457 mm) of compacted subgrade
18. Subgrade: 18" (457 mm) of compacted subgrade
19. Subgrade: 18" (457 mm) of compacted subgrade
20. Subgrade: 18" (457 mm) of compacted subgrade

GENERAL

1. The contractor shall be responsible for obtaining all necessary permits and approvals from the appropriate authorities.
2. The contractor shall be responsible for providing all necessary materials and equipment for the project.
3. The contractor shall be responsible for providing all necessary labor for the project.
4. The contractor shall be responsible for providing all necessary supervision for the project.
5. The contractor shall be responsible for providing all necessary safety measures for the project.
6. The contractor shall be responsible for providing all necessary environmental protection for the project.
7. The contractor shall be responsible for providing all necessary erosion control measures for the project.
8. The contractor shall be responsible for providing all necessary stormwater management measures for the project.
9. The contractor shall be responsible for providing all necessary site access measures for the project.
10. The contractor shall be responsible for providing all necessary site security measures for the project.
11. The contractor shall be responsible for providing all necessary site cleanup measures for the project.
12. The contractor shall be responsible for providing all necessary site restoration measures for the project.
13. The contractor shall be responsible for providing all necessary site monitoring measures for the project.
14. The contractor shall be responsible for providing all necessary site reporting measures for the project.
15. The contractor shall be responsible for providing all necessary site record keeping measures for the project.
16. The contractor shall be responsible for providing all necessary site communication measures for the project.
17. The contractor shall be responsible for providing all necessary site coordination measures for the project.
18. The contractor shall be responsible for providing all necessary site cooperation measures for the project.
19. The contractor shall be responsible for providing all necessary site assistance measures for the project.
20. The contractor shall be responsible for providing all necessary site support measures for the project.

CONTRACT SPECIFICATIONS

1. All materials shall be of good quality and conform to the specifications of the appropriate authorities.
2. All workmanship shall be of good quality and conform to the specifications of the appropriate authorities.
3. All construction shall be completed within the specified time frame.
4. All construction shall be completed within the specified budget.
5. All construction shall be completed within the specified safety requirements.
6. All construction shall be completed within the specified environmental requirements.
7. All construction shall be completed within the specified erosion control requirements.
8. All construction shall be completed within the specified stormwater management requirements.
9. All construction shall be completed within the specified site access requirements.
10. All construction shall be completed within the specified site security requirements.
11. All construction shall be completed within the specified site cleanup requirements.
12. All construction shall be completed within the specified site restoration requirements.
13. All construction shall be completed within the specified site monitoring requirements.
14. All construction shall be completed within the specified site reporting requirements.
15. All construction shall be completed within the specified site record keeping requirements.
16. All construction shall be completed within the specified site communication requirements.
17. All construction shall be completed within the specified site coordination requirements.
18. All construction shall be completed within the specified site cooperation requirements.
19. All construction shall be completed within the specified site assistance requirements.
20. All construction shall be completed within the specified site support requirements.

CONTRACT NOTES

1. The contractor shall be responsible for providing all necessary materials and equipment for the project.
2. The contractor shall be responsible for providing all necessary labor for the project.
3. The contractor shall be responsible for providing all necessary supervision for the project.
4. The contractor shall be responsible for providing all necessary safety measures for the project.
5. The contractor shall be responsible for providing all necessary environmental protection for the project.
6. The contractor shall be responsible for providing all necessary erosion control measures for the project.
7. The contractor shall be responsible for providing all necessary stormwater management measures for the project.
8. The contractor shall be responsible for providing all necessary site access measures for the project.
9. The contractor shall be responsible for providing all necessary site security measures for the project.
10. The contractor shall be responsible for providing all necessary site cleanup measures for the project.
11. The contractor shall be responsible for providing all necessary site restoration measures for the project.
12. The contractor shall be responsible for providing all necessary site monitoring measures for the project.
13. The contractor shall be responsible for providing all necessary site reporting measures for the project.
14. The contractor shall be responsible for providing all necessary site record keeping measures for the project.
15. The contractor shall be responsible for providing all necessary site communication measures for the project.
16. The contractor shall be responsible for providing all necessary site coordination measures for the project.
17. The contractor shall be responsible for providing all necessary site cooperation measures for the project.
18. The contractor shall be responsible for providing all necessary site assistance measures for the project.
19. The contractor shall be responsible for providing all necessary site support measures for the project.
20. The contractor shall be responsible for providing all necessary site maintenance measures for the project.

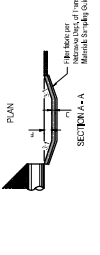
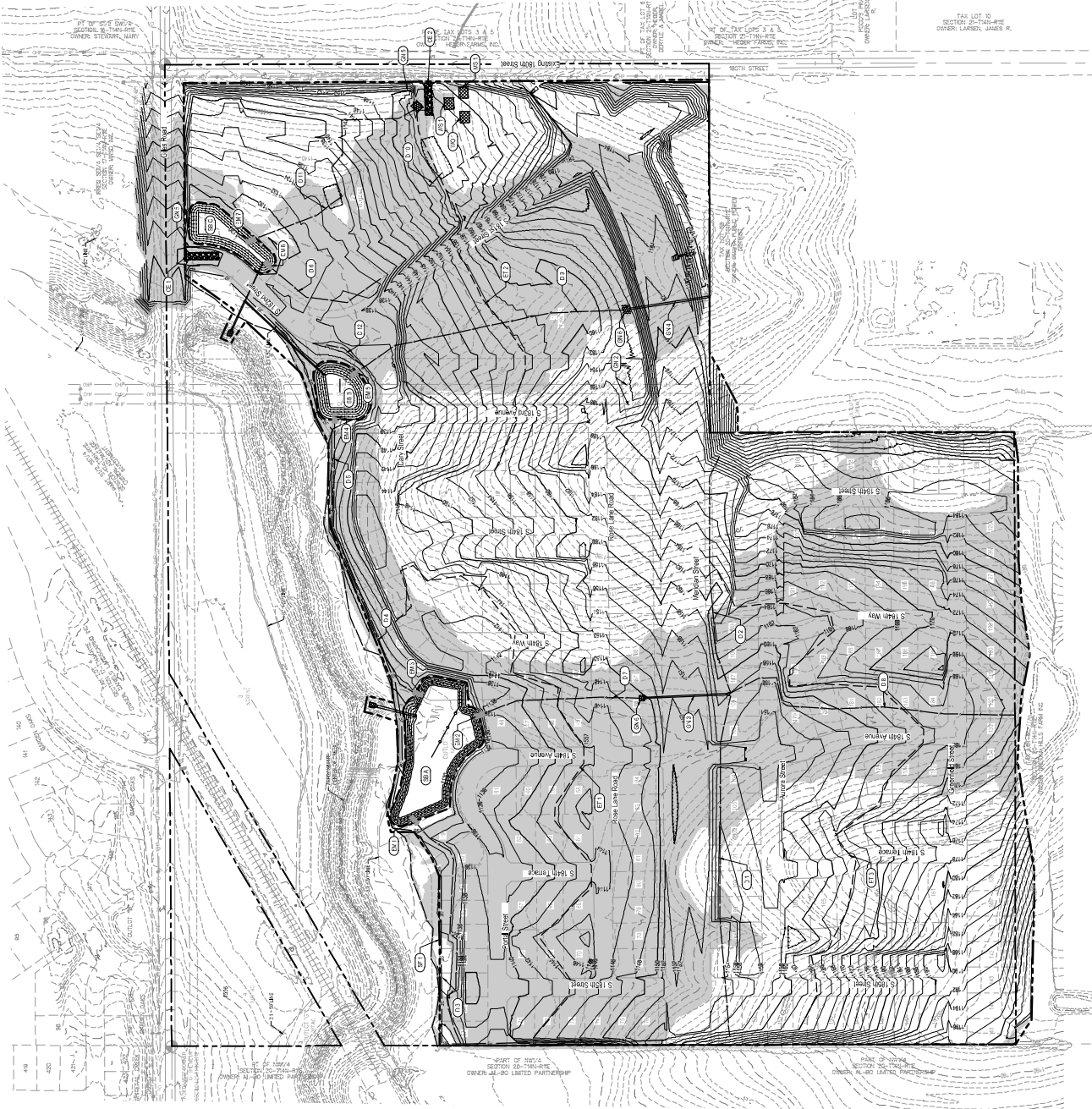

SECTION A-A
Stormwater Management Structure
Manufactured by [Manufacturer Name]

SCOUR HOLE TABLE

Type	Area	C	D	E	F	Flow Type	Flow Quantity (cfs)	Flow Velocity (ft/s)
1	1	2	3	4	5	6	7	8
2	9	10	11	12	13	14	15	16
3	17	18	19	20	21	22	23	24
4	25	26	27	28	29	30	31	32
5	33	34	35	36	37	38	39	40
6	41	42	43	44	45	46	47	48
7	49	50	51	52	53	54	55	56
8	57	58	59	60	61	62	63	64
9	65	66	67	68	69	70	71	72
10	73	74	75	76	77	78	79	80

WINDSOR WEST
1025 SOUTH STREET, WESTYORK, NEW YORK

OUT AND FILL TACKS

WINDSOR WEST
 1025 - 1035 S. WINDSOR WAY, WINDSOR, NEBRASKA
 GRADING & STORMWATER POLLUTION PREVENTION PLAN



E & A CONSULTING GROUP, INC.
 Engineering • Planning • Environmental & Field Services
 10000 W. 103rd St., Suite 100, Overland Park, KS 66204
 Phone: 913.551.9200 Fax: 913.551.9201

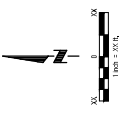

LEGEND

- Power Pole
- Open Well
- Light Pole
- Fire Hydrant
- Utility (Water/Wire)
- City Meter
- Manhole
- Storm Sewer
- Sanitary Sewer
- Gas Line
- Water Line
- Power Line (Overhead)
- Concrete Basin
- SB Trench
- Grading Contour
- Proposed Contour
- Limit of Construction
- Enter Street Elevation
- Fill Area

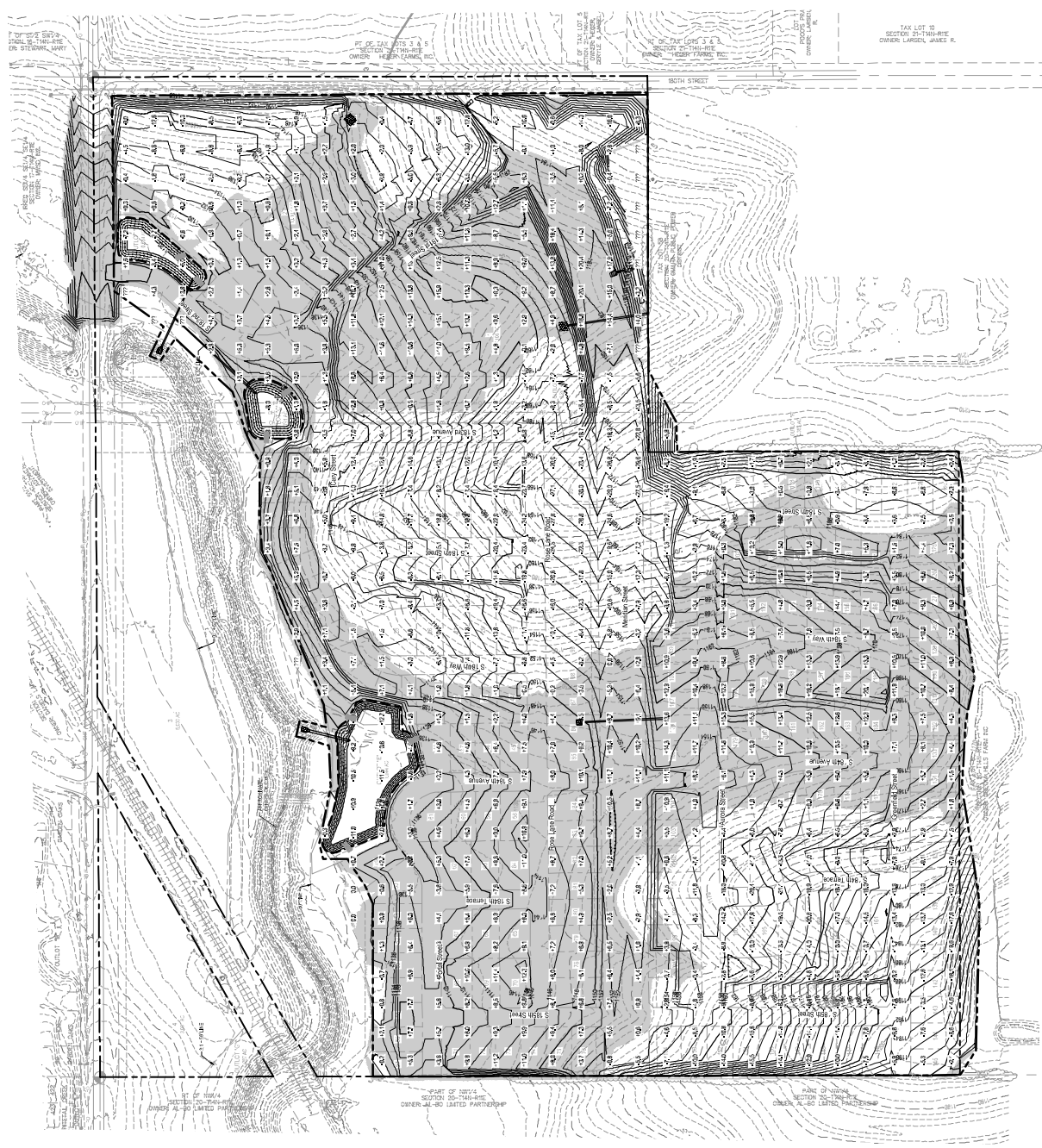
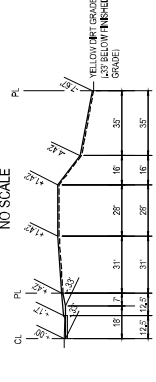
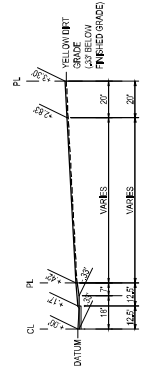

108
 Nebraska
 PROFESSIONAL ENGINEERS
 108-001

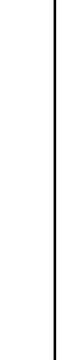
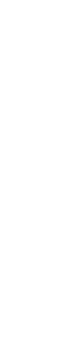
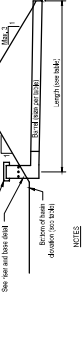
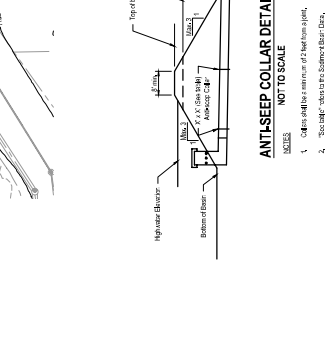
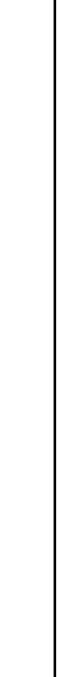
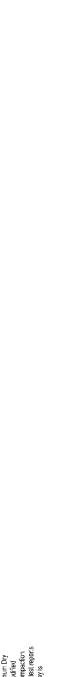
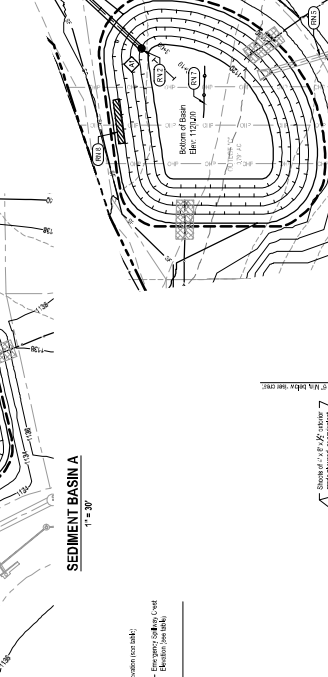
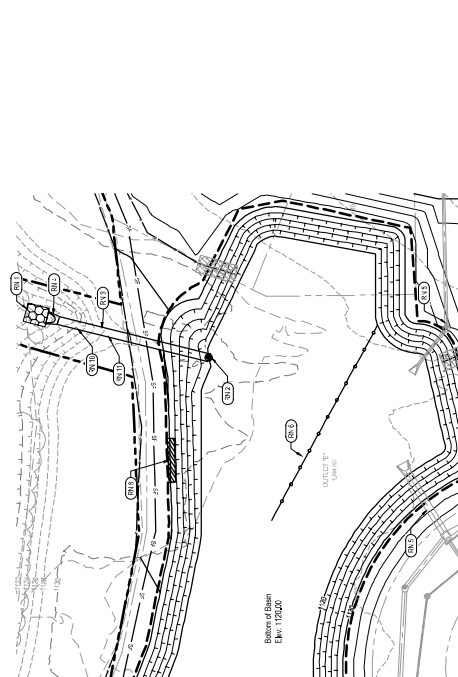
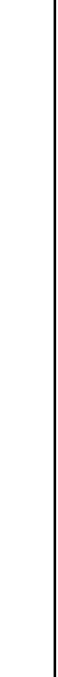
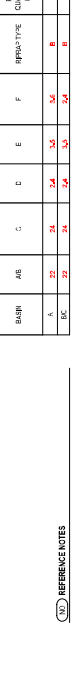
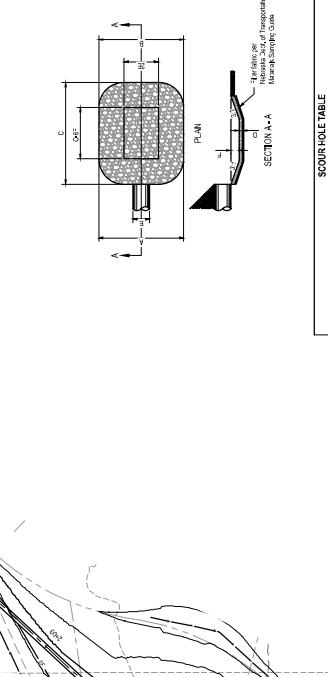
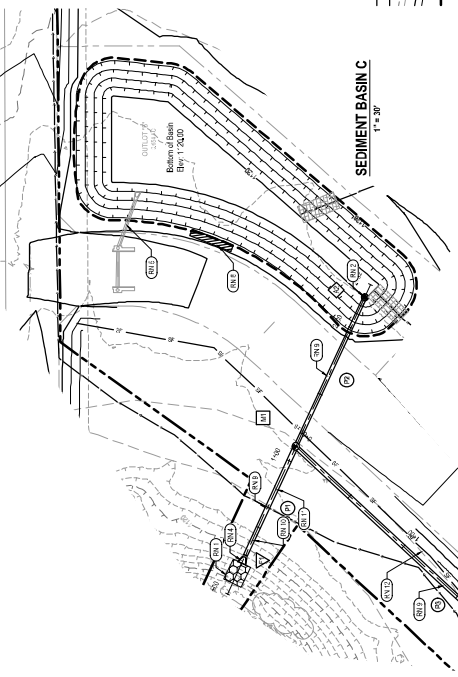

CONSTRUCT AREA IN ET

ID	Item No.	Description	Quantity	Unit	Notes
A1	2486.00	Excavation - 12" x 12" x 12"	7886.00	SF	
A2	2487.00	Excavation - 18" x 18" x 18"	7700.00	SF	

CONSTRUCT STORM SEWER MANHOLE

ID	Item No.	Description	Quantity	Unit	Notes
M1	1410.00	Manhole - 36" Dia. x 10' High	1	EA	

CONSTRUCT FLARED END SECTION

ID	Item No.	Description	Quantity	Unit	Notes
F1	1250.00	Flared End Section - 36" Dia. x 10' Long	1	EA	

CONSTRUCT REINFORCED CONCRETE PIPE

ID	Item No.	Description	Quantity	Unit	Notes
P1	1410.00	Reinforced Concrete Pipe - 36" Dia. x 10' Long	1	EA	

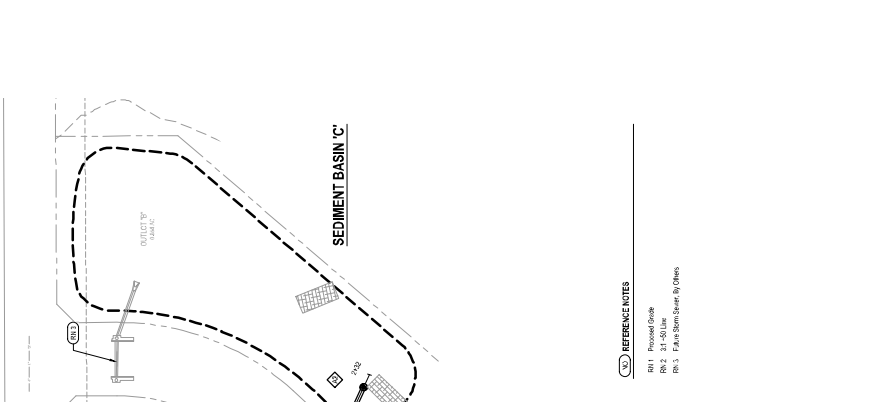

REFERENCE NOTES

RM 1 Proposed Grade
 RM 2 3.1'-5.0' Limit
 RM 3 Plan Form Bases By Others

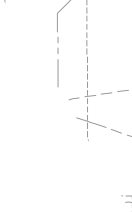

LEGEND

- Proposed Storm Sewer
- Proposed Manhole
- Proposed Pipe
- Proposed Flared End Section
- Proposed Sediment Basin
- Proposed Outlet
- Proposed Inlet
- Proposed Catchment Area
- Proposed Right-of-Way
- Proposed Easement
- Proposed Property Line
- Proposed Road
- Proposed Utility
- Proposed Structure
- Proposed Tree
- Proposed Plant
- Proposed Landmark
- Proposed Survey Point
- Proposed Benchmark
- Proposed Spot Elevation
- Proposed Finish Elevation
- Proposed Existing Feature
- Proposed Proposed Feature

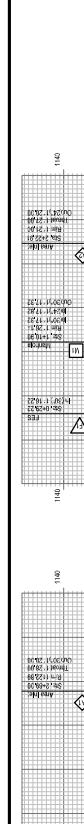

DRAINAGE MAP
 WINDSOR WEST
 1202 S. HANCOCK STREET, WINDSOR, WI
 GRADING & STORMWATER POLLUTION PREVENTION PLAN
 E & A CONSULTING GROUP, INC.



LEGEND

- Proposed Grading
- Proposed Stormwater Management
- Proposed Stormwater Pollution Prevention
- Proposed Stormwater Detention
- Proposed Stormwater Treatment
- Proposed Stormwater Storage
- Proposed Stormwater Conveyance
- Proposed Stormwater Outfall
- Proposed Stormwater Inlet
- Proposed Stormwater Manhole
- Proposed Stormwater Catch Basin
- Proposed Stormwater Filter
- Proposed Stormwater Sedimentation
- Proposed Stormwater Retention
- Proposed Stormwater Diversion
- Proposed Stormwater Bypass
- Proposed Stormwater Control
- Proposed Stormwater Barrier
- Proposed Stormwater Structure
- Proposed Stormwater Facility
- Proposed Stormwater System
- Proposed Stormwater Network
- Proposed Stormwater Infrastructure
- Proposed Stormwater Assets
- Proposed Stormwater Resources
- Proposed Stormwater Services
- Proposed Stormwater Solutions
- Proposed Stormwater Strategies
- Proposed Stormwater Initiatives
- Proposed Stormwater Programs
- Proposed Stormwater Policies
- Proposed Stormwater Procedures
- Proposed Stormwater Practices
- Proposed Stormwater Standards
- Proposed Stormwater Guidelines
- Proposed Stormwater Specifications
- Proposed Stormwater Requirements
- Proposed Stormwater Criteria
- Proposed Stormwater Parameters
- Proposed Stormwater Indicators
- Proposed Stormwater Metrics
- Proposed Stormwater Measures
- Proposed Stormwater Interventions
- Proposed Stormwater Actions
- Proposed Stormwater Responses
- Proposed Stormwater Outcomes
- Proposed Stormwater Impacts
- Proposed Stormwater Benefits
- Proposed Stormwater Risks
- Proposed Stormwater Opportunities
- Proposed Stormwater Challenges
- Proposed Stormwater Solutions
- Proposed Stormwater Strategies
- Proposed Stormwater Initiatives
- Proposed Stormwater Programs
- Proposed Stormwater Policies
- Proposed Stormwater Procedures
- Proposed Stormwater Practices
- Proposed Stormwater Standards
- Proposed Stormwater Guidelines
- Proposed Stormwater Specifications
- Proposed Stormwater Requirements
- Proposed Stormwater Criteria
- Proposed Stormwater Parameters
- Proposed Stormwater Indicators
- Proposed Stormwater Metrics
- Proposed Stormwater Measures
- Proposed Stormwater Interventions
- Proposed Stormwater Actions
- Proposed Stormwater Responses
- Proposed Stormwater Outcomes
- Proposed Stormwater Impacts
- Proposed Stormwater Benefits
- Proposed Stormwater Risks
- Proposed Stormwater Opportunities
- Proposed Stormwater Challenges

